

Date: _____ Account Number: _____ Account Name: _____
 Contact Person: _____ Phone: _____ Customers Signature: _____

Quantity: _____

Capacity: Light Wall 22.5K (Air Suspension not available for light wall options)
 Medium Wall 25K
 Heavy Wall 27.5K

Axle Type: Beam only Idler Axle Brake Axle Beam and Brake

Track Width: _____ or **Hub Face:** _____ **Spring Center:** _____

Brake Size: 12¼ x 7½ used with 17.5" & 19.5" wheels
 16½ x 7 used with 22.5" & 24.5" wheels

Bearing Lubrication: Grease Oil

Chambers: Type 30 Type 30/30 Type 30/30 (Mounted) No Chambers

Cam Length: Standard Length Other: _____

Slacks: Manual Adjust Automatic Adjust No Slacks

Hub Bolt Pattern: (12¼ x 7½" Brake)

- 3 Spoke Hub & Drum (17.5" Rims)
- 8 on 275mm - Hub Piloted (Flange Nut)
- *Long Studs Yes
- 10 on 8¾ - Stud Piloted (Budd Nut)

Hub Bolt Pattern: (16½ x 7" Brake)

- 5 Spoke Hub & Drum (22.5" Rims)
- 10 on 285.75mm - Hub Piloted (Flange Nut)
- *Long Studs Yes
- 10 on 11¼" - Stud Piloted (Budd Nut)

Seals: Standard Stemco Voyager Stemco Guardian

ABS Package : (Sensors, Blocks, & Tone Rings)

Haldex Wabco (select sensor brand)

Spring Seats: Under slung (HDSS Suspension) NONE

Spring Capacity with HDSS:

- 11,250# (22,500 per axle)
- 12,500# (25,000 per axle)

Painted: Yes No

Dust Shields: (16½" Brakes Only)

Tire Inflation Axle Prep:

Pressure Guard Meritor (MTIS) Hendrickson (Tiremaxx)

Notes: _____

Southwest Wheel -- 210-226-0301 San Antonio & Corpus Christi

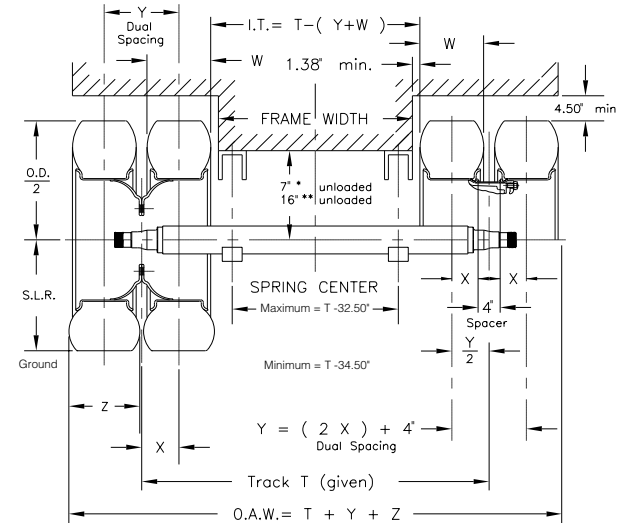

Underslung > Using ¾" seat height and 3 leaf - 354-00 spring (standard Dexter HAP Kits)
 Overslung >

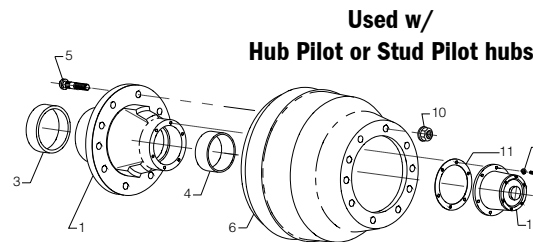

Outboard Drums - Only available w/ 8 on 275mm. 10 on 11.25 & 10 on 285.75mm
 Order w/Outboard Drums

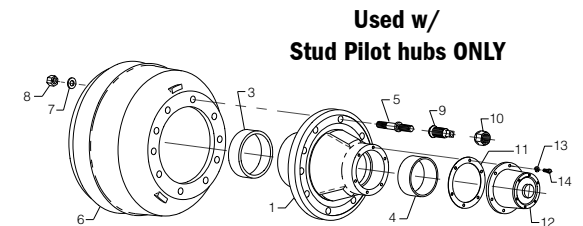

Inboard Drums
 Order w/Inboard Drums