

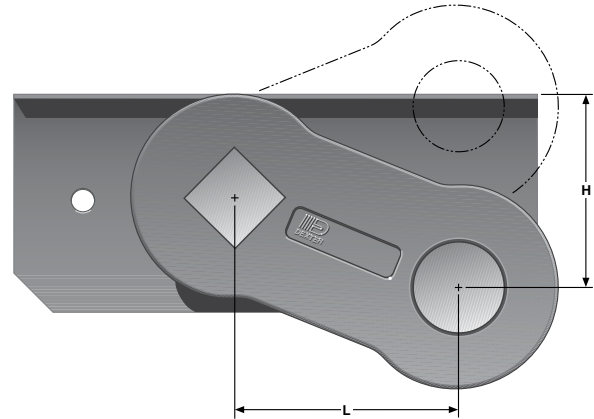

Articulation Dimensions

Dimensions are for high profile, top mount only. Side mount is .31" higher. Allow 3" bump clearance from full load.

| Start Angle | Bracket Profile | No Load | | Full Load | | Shock Load | |
|-------------|-----------------|---------|------|-----------|------|------------|------|
| | | H | L | H | L | H | L |
| 45° Down | High | 7.68 | 4.24 | 5.74 | 5.54 | 4.74 | 5.83 |
| 32° Down | High | 6.62 | 5.09 | 4.43 | 5.92 | 3.44 | 5.84 |
| 22.5° Down | High | 5.74 | 5.54 | 3.44 | 6.00 | 2.40 | 5.91 |
| 10° Down | High | 4.48 | 5.91 | 2.14 | 5.86 | 1.14 | 5.54 |
| 0° | High | 3.44 | 6.00 | 1.14 | 5.54 | 0.22 | 5.06 |
| 10° Up | High | 2.40 | 5.91 | 0.22 | 5.06 | 0.39 | 4.42 |
| 22.5° Up | High | 1.14 | 5.54 | -0.80 | 4.24 | -1.47 | 3.44 |



Note: Positive numbers in the H column indicate the spindle is BELOW the top of the bracket. Conversely, negative numbers are ABOVE the top of the bracket.

Overhang Per Side

| Spindle | Min. | Brake |
|---------|--------|-----------|
| #14 | 12.75" | 12¼" x 5" |

Note: One-piece hub/drum is not interchangeable with the two-piece hub & drum.



Full Load Dimensions

Dimensions are for high profile, top mount only. Side mount is .31" higher. Allow 3" bump clearance from full load.

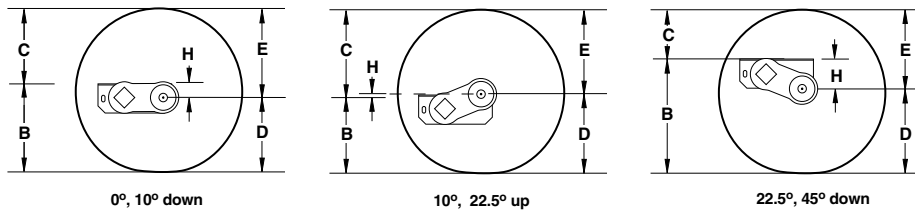

Start Angle

| Tire | * ** | | 45° Down | | | 32° Down | | | 22.5° Down | | | 10° Down | | | 0° | | | 10° Up | | | 22.5° Up | | |
|-------------|------|------|----------|------|------|----------|------|------|------------|------|------|----------|------|------|-----|------|------|--------|------|------|----------|------|------|
| | D | E | H | B | C | H | B | C | H | B | C | H | B | C | H | B | C | H | B | C | H | B | C |
| LT235/85R16 | 14.3 | 15.4 | 5.7 | 20.0 | 9.70 | 4.4 | 18.7 | 11.0 | 3.4 | 17.7 | 12.0 | 2.1 | 16.4 | 13.3 | 1.1 | 15.4 | 14.3 | .2 | 14.5 | 15.2 | -0.8 | 13.5 | 16.2 |
| 215/75R17.5 | 14.0 | 15.3 | 5.7 | 19.7 | 9.60 | 4.4 | 18.4 | 10.9 | 3.4 | 17.4 | 11.9 | 2.1 | 16.1 | 13.2 | 1.1 | 15.1 | 14.2 | .2 | 14.2 | 15.1 | -0.8 | 13.2 | 16.1 |
| 235/75R17.5 | 14.3 | 15.7 | 5.7 | 20.0 | 10.0 | 4.4 | 18.7 | 11.3 | 3.4 | 17.7 | 12.3 | 2.1 | 16.4 | 13.6 | 1.1 | 15.4 | 14.6 | .2 | 14.5 | 15.5 | -0.8 | 13.5 | 16.5 |
| 9R17.5HC | 15.4 | 17.1 | 5.7 | 21.1 | 11.4 | 4.4 | 19.8 | 12.7 | 3.4 | 18.8 | 13.7 | 2.1 | 17.5 | 15.0 | 1.1 | 16.5 | 16.0 | .2 | 15.6 | 16.9 | -0.8 | 14.6 | 17.9 |
| 10R17.5HC | 15.6 | 18.0 | 5.7 | 21.3 | 12.3 | 4.4 | 20.0 | 13.6 | 3.4 | 19.0 | 14.6 | 2.1 | 17.7 | 15.9 | 1.1 | 16.7 | 16.9 | .2 | 15.8 | 17.8 | -0.8 | 14.8 | 18.8 |

Columns D and E are dimensional examples only:

* D – Static Loaded Radius

** E – Inflated Radius

#14 Bracket Dimensions

| | |
|-----------|---------|
| A | ---- |
| B | 4.50 |
| C | 9.00 |
| D | ---- |
| E | 12.00 |
| F | 4.50 |
| G | ---- |
| J | 2.44 |
| L | ---- |
| P | ---- |
| Q | ---- |
| Bolt Size | ¾" bolt |
| Tube Size | 4.25 |

